



30 Mulberry Court

Warmsworth, Doncaster, DN4 9GD

Price Guide £165,000

GUIDE PRICE £165,000 - £170,000 Situated in an excellent cul-de-sac location is this three-bedroom townhouse. In brief the property comprises an entrance hall, ground floor WC, lounge, and an open-plan kitchen/diner. To the first floor are three well-proportioned bedrooms along with a family bathroom fitted with a modern white three-piece suite. Externally, the property benefits from a lawned front garden and a driveway providing off-road parking. Gated side access leads to a fully enclosed rear garden with fenced boundaries. Conveniently positioned close to local amenities and motorway links, early viewing is highly advised.

- End town house
- Three bedrooms
- Open-plan dining kitchen
- Downstairs WC
- Modern family bathroom
- Quiet cul-de-sac position
- Driveway for two vehicles
- Close to amenities and motorway connections
- Viewing highly recommended
- Call 01302 751616

Viewing

Please contact our Office on 01302 751616 if you wish to arrange a viewing appointment for this property or require further information.



Floor Plan

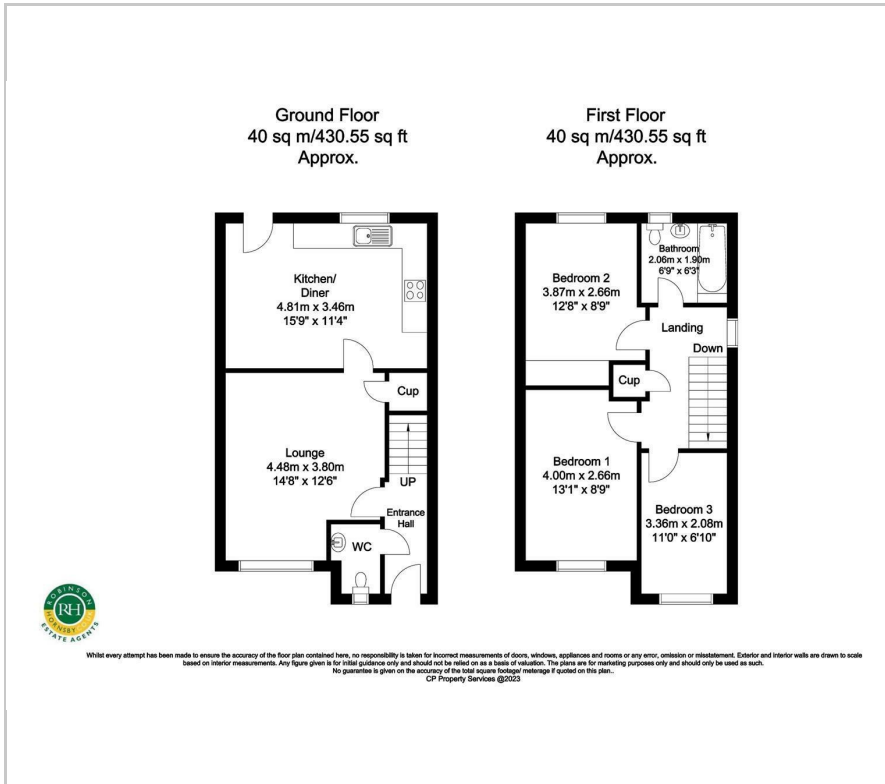

Area Map



Energy Efficiency Graph

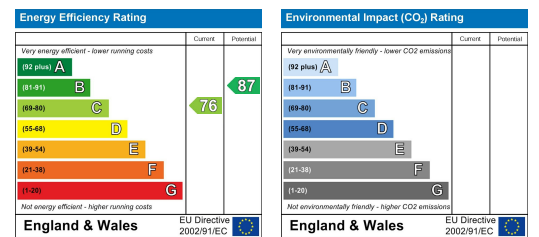

These particulars, whilst believed to be accurate are set out as a general outline only for guidance and do not constitute any part of an offer or contract. Intending purchasers should not rely on them as statements of representation of fact, but must satisfy themselves by inspection or otherwise as to their accuracy. No person in this firm's employment has the authority to make or give any representation or warranty in respect of the property.